

REHABILITATION NOTES

1. The area to be rehabilitated is 51.2 hectares.
2. This site is to be rehabilitated to natural environment and agricultural after uses.
3. The sequence and direction of rehabilitation is as follows. Perimeter slopes shall be rehabilitated as the limits of extraction are reached. Slopes shall be no steeper than 3:1. Below water slopes and shoreline zones will vary from 1:1 to 10:1 (typical) to enhance shoreline diversity. Slopes shall be created by excavation or by backfilling with onsite overburden and spread with topsoil (minimum depth 0.15m) and a grass/legume mixture such as alfalfa and red clover.
4. Rehabilitation operations such as stripping and earth moving shall take place only when the soil is dry to reduce compacting of the soils.
5. Agricultural uses will continue in perimeter areas around the future pond. Where possible the size of the pond will be minimized and the depth maximized where feasible. This will keep as much as possible of the rehabilitated areas above water available for agricultural uses.
6. During rehabilitation in the agricultural areas the soils shall be replaced in a manner that approximates the original soil profile. Prior to soil placement compacted areas of the pit floor shall be ripped and scarified. As such, it is expected that the same average soil capability will be restored.
7. Rehabilitated areas shall be planted with a grass/legume mixture such as alfalfa and red clover. Rehabilitated areas shall be ploughed under in the fall of the first year and reseeded the following spring to enhance soil structure.
8. Areas shall be graded to direct drainage towards the pond as shown. Most surface water in perimeter areas will percolate into the ground.
9. Rehabilitated areas are to be re-graded and reseeded in the event of washouts.
10. Any vegetation that dies or is otherwise damaged shall be reseeded or replanted.
11. Shoreline zones may be sculpted where practical to enhance the natural environment aspects and biodiversity of the pond.
12. Islands may be constructed where possible to enhance wildlife habitat. Minimum grades around the island perimeters shall be no steeper than 3:1.
13. The elevation of the water table varies from +/-298m ASL to +/-301m ASL. The elevation of the water table was taken from Fig. 3 in the report by GSS Engineering Consultants Ltd. (September, 2014) titled: "Hydrogeologic Investigation - Kinghurst Aggregates Ltd. - (Taylor Pit)". The final pond elevation after rehabilitation is completed will be approximately 299.5m ASL.

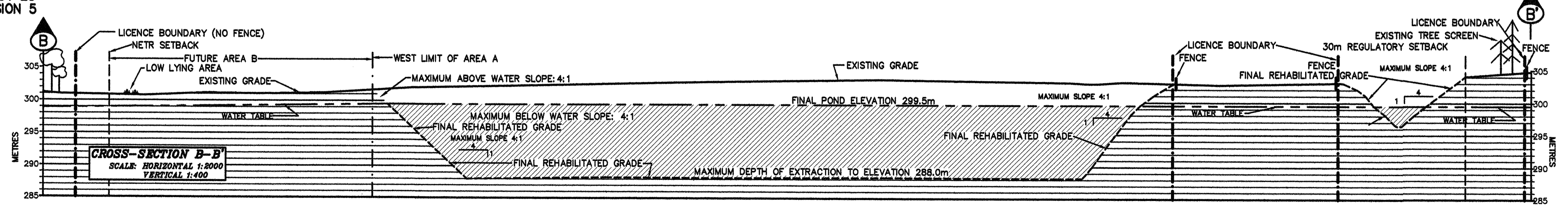
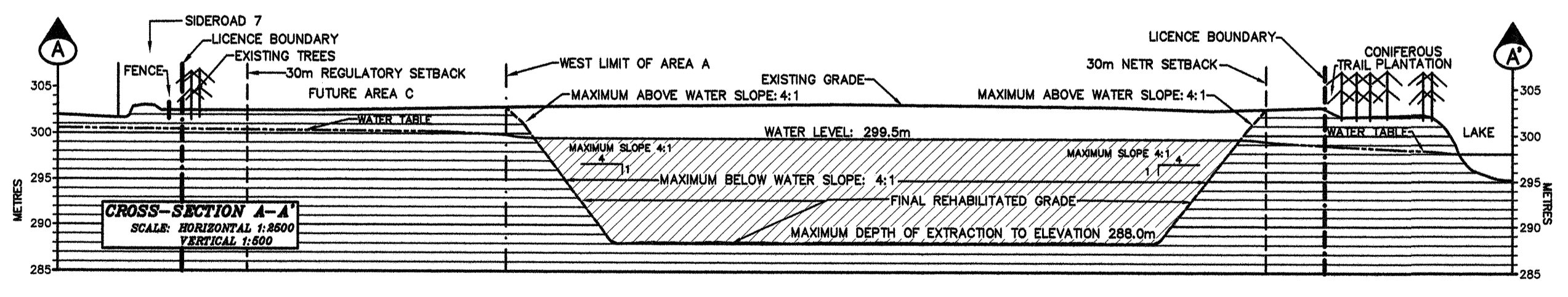
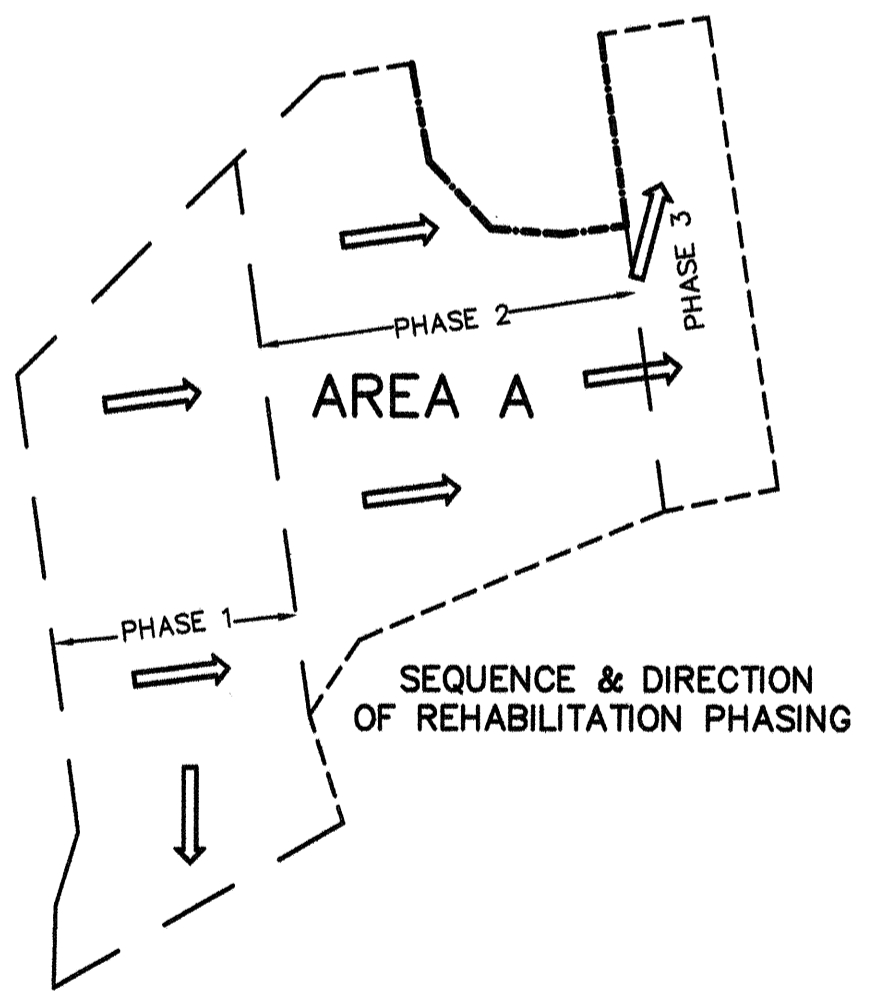
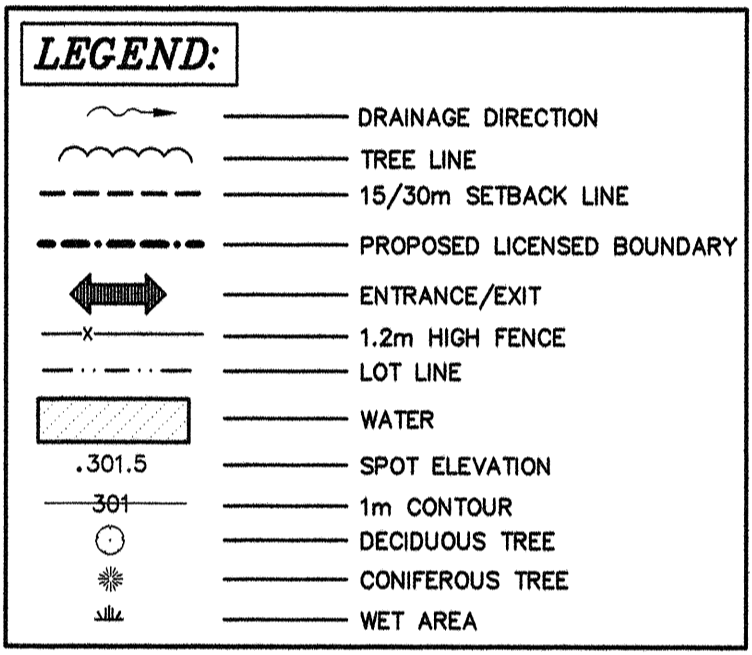

KINGHURST AGGREGATES LTD.
11 FIRST AVENUE NORTH, APT. #4, PO BOX 236
CHESLEY, ONTARIO, N0G 1L0

TAYLOR PIT
PART LOTS 22 & 23, CONCESSION 5
TOWNSHIP OF CHATSWORTH (formerly Sullivan Twp)
COUNTY OF GREY

PROGRESSIVE REHABILITATION AND FINAL REHABILITATION PLANS
DRAWING 4 OF 4
SCALE: 1:2500

No.	AMENDMENT	DATE